

# CELEBRITY MILLENNIUM® CLASS SUITE CLASS AMENITIES

AMENITIES	PENTHOUSE SUITES	ROYAL SUITES	CELEBRITY SUITES	SKY SUITES
<b>DINING</b>				
Luminae - Exclusive restaurant serving complimentary breakfast, lunch**, and dinner	✓	✓	✓	✓
Full in-suite breakfast, lunch, and dinner service	✓	✓	✓	✓
<b>SERVICES</b>				
Personal butlers - To help with packing and unpacking, making dining reservations, spa appointments, and more	✓	✓	✓	✓
Onboard Destination Concierge	✓	✓	✓	✓
Priority check-in when boarding the ship	✓	✓	✓	✓
Priority embarkation in all ports of call	✓	✓	✓	✓
Priority debarkation	✓	✓	✓	✓
Reserved theater seating on formal nights	✓	✓	✓	✓
<b>COMPLIMENTARY AMENITIES/EXPERIENCES</b>				
Daily delivery of afternoon savories	✓	✓	✓	✓
In-suite afternoon tea service	✓	✓	✓	✓
Luxury bath amenities	✓	✓	✓	✓
Michael's Club - Private lounge with dedicated Concierge service and unique food and beverage experiences	✓	✓	✓	✓
<b>PREMIUM "ALL-IN" BENEFITS</b>				
Complimentary premium beverage package	✓	✓		
Unlimited complimentary specialty dining	✓	✓		
Unlimited internet access	✓	✓		
Complimentary mini bar of beer, soda, and water (stocked daily)	✓	✓		
Two complimentary bottles of alcohol with mixers	✓	✓		

## ADDITIONAL AMENITIES INCLUDE:

### Service:

- Twice daily maid service (makeup and turndown)
- Priority tender service
- Our signature friendly, personalized service with a guest to staff ratio of nearly 2:1
- 24-hour room service
- Expanded room service breakfast menu
- Laundry service\*
- Complimentary beach towel service, shoeshine service, use of golf umbrella and binoculars

### Dining:

- Main and specialty restaurant seating preferences

### Amenities:

- Premium Reverie Dream® Mattress, with customizable firmness cylinders
- Celebrity eXhale™ bedding featuring custom premium mattresses, plush duvets and pillows, and 100% cotton linens
- Welcome Blanc de Blancs sparkling wine with a commemorative label featuring exclusive artwork from the ArtCenter/South Florida artists

- Welcome fresh fruit
- Flowers
- Complimentary espresso and cappuccino (in suite)
- Pillow menu
- Plush 100% cotton bathrobes
- 100% cotton oversized bath towels

### Suite features:

- Veranda with lounge seating
- Dual iPod®/iPad® docking station
- Hansgrohe® massaging showerhead
- Floor-to-ceiling sliding glass doors
- Sitting area with sofa

- Two lower beds convertible to queen (except as noted)
- Some staterooms may have a trundle bed
- Dual voltage 110/220 AC
- Plentiful storage space in your bathroom and wardrobe
- Samsung® interactive flat screen TVs with multiple channels and interactive TV that allows you to check your bill, make shore excursion reservations, order room service, watch shows and movies on demand\*\*
- Individual safe
- Mini-bar\*



### PENTHOUSE SUITE

1,432 sq. ft.  
veranda 1,098 sq. ft.

PS

- Baby grand piano
- Butler's Pantry
- Veranda with whirlpool and lounge seating
- King size bed
- Marble master bath with whirlpool tub
- Powder room



Furniture configuration shown may vary in staterooms with third- and fourth-guest capacity. All measurements are approximate.

Visit [celebritycruises.com](http://celebritycruises.com), call us at 1-800-852-7239, or contact your travel agent.



**ROYAL SUITE** RS

538 sq. ft.  
veranda 195 sq. ft.

- Separate living room with dining and sitting area
- Walk-in closet
- Veranda with whirlpool tub
- Tub with whirlpool jets



**CELEBRITY SUITE** CS

467 sq. ft.  
veranda 85 sq. ft.

- Walk-in closet with vanity table
- Tub with whirlpool jets
- Glass enclosed sitting area



**SKY SUITE** S1 S2 †

251 sq. ft.  
veranda 57 sq. ft.

- Veranda with lounge seating



\*Additional charges apply.

\*\*Lunch only available on select days.

† Some suites and staterooms are accessible for wheelchair users and other guests with disabilities. They include automatic doors (on Solstice Class only), roll-in showers, grab bars, and other accessible features. Please see the specific ship deck plans for the locations of all wheelchair accessible suites. For more details, visit [celebritycruises.com/accessiblestaterooms](http://celebritycruises.com/accessiblestaterooms).

## AQUACLASS® STATEROOMS

Includes most Concierge Class & stateroom amenities plus:

### Service:

- Expanded room service breakfast menu
- Special invitation to a VIP tour of the spa on embarkation day

### Dining:

- Specialty restaurant, Blu, created just for AquaClass guests, serving complimentary, healthy continental breakfast daily, and an unforgettable contemporary dinner nightly

### Amenities:

- Hansgrohe® "shower tower"
- Aromatherapy diffuser
- Euro face towel
- Additional custom blended bath products: facial spray and lip balm
- Reverie Dream Lite® Mattress

- Pillow menu to customize your night's sleep
- Welcome bottled water
- Daily delivery of flavored tea
- Plush 100% cotton bathrobes and slippers

### Stateroom features:

- Double occupancy
- Free, unlimited access to Persian Garden spa lounge with heated tile loungers
- Wellness Channel - On Demand AquaClass Programming: Meditation, Yoga, and Ayurveda



### AQUACLASS® STATEROOM

194 sq. ft.  
veranda 54 sq. ft.

A1 A2

PREMIUM SHIP LOCATION, STEPS FROM THE CANYON RANCH SPA CLUB®.

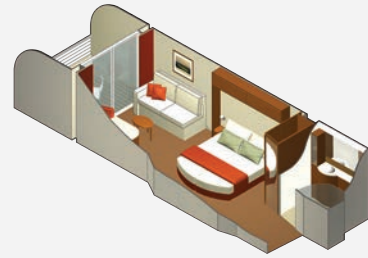

### CONCIERGE CLASS STATEROOM

204 sq. ft.  
veranda 42 sq. ft.

C1 \*\* C2 C3

LOCATED IN THE MOST DESIRABLE LOCATIONS OF THE SHIP.

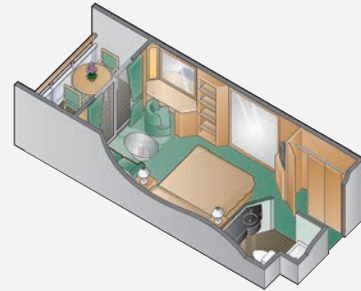

### FAMILY VERANDA STATEROOM

270 sq. ft.  
veranda 112 or 191 sq. ft.

FV



Furniture configuration shown may vary in staterooms with third- and fourth-guest capacity. All measurements are approximate.

Visit [celebritycruises.com](http://celebritycruises.com), call us at 1-800-852-7239, or contact your travel agent.

# STATEROOMS AMENITIES

## Service:

- Our signature friendly, personalized service with a guest to staff ratio of nearly 2:1
- Twice daily maid service (makeup and turnaround)
- 24-hour room service
- Fresh ice delivered to stateroom upon request
- Laundry service\*
- Complimentary beach towel service

## Dining:

- Breakfast, lunch, and dinner available in a variety of restaurants

## Amenities:

- Reverie Dream Lite Mattress
- 100% cotton linens and plush down comforters and pillows
- Four pillows in every stateroom
- Complimentary use of bathrobes
- 100% cotton towels
- Hair dryer
- Custom blended bath products (shampoo, conditioner, lotion, shower cap and soap, cotton balls, and cotton swabs)
- Complimentary tote bag

## Stateroom features:

- Two lower beds convertible to queen (except as noted)
- Some staterooms may have a trundle bed
- Dual voltage 110/220 AC
- Plentiful storage space in your bathroom and wardrobe
- Interactive flat screen TVs with multiple channels and interactive TV that allows you to check your bill, make shore excursion reservations, order room service, watch shows and movies on demand\*
- Individual safe
- Mini-bar\*



### VERANDA STATEROOM

170 sq. ft.  
veranda 38 sq. ft.

2A \*\* 2B \*\* 2C

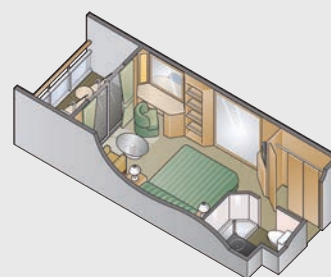

### OCEAN VIEW STATEROOM

170 sq. ft.

4 5 \*\* 6 7 8

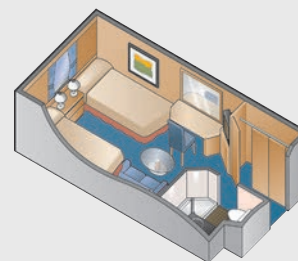

### INSIDE STATEROOM

170sq. ft.

9 \*\* 10 \*\* 11 \*\* 12

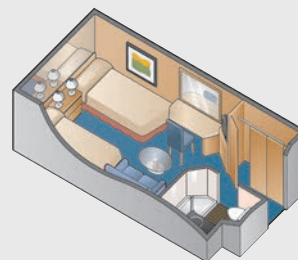

\*Additional charges apply.

\*\* Some suites and staterooms are accessible for wheelchair users and other guests with disabilities. They include roll-in showers. Please see the specific ship deck plans for the locations of all wheelchair accessible suites. For more details, visit [celebritycruises.com/accessiblestaterooms](http://celebritycruises.com/accessiblestaterooms).